

# Technical data sheet

## Support clamp, with pipe seat at side

Item number: 1488413



Support clamp for mounting pipes. Open pipe seat at side. Fastening through knocking onto steel girders.



CE

- St Steel
- ZL Zinc slat

### Master data

Item number	1488413
Description 1	Beam clamp
Description 2	with pipe clamp 25 mm
Manufacturer	OBO
Dimension	1,5-4mm
Material	Steel
Surface	Zinc slat
Surface standard	
Smallest sales unit	50
Unit of quantity	Piece
Weight	2 kg
Weight unit	kg/100 pc.

# Technical data sheet

## Support clamp, with pipe seat at side

Item number: 1488413



### Dimensions

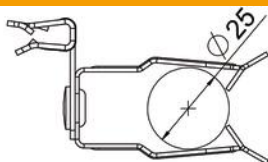

Length	59 mm
Width	28 mm
Height	32 mm
Dimension L	59 mm
Maß W	28 mm

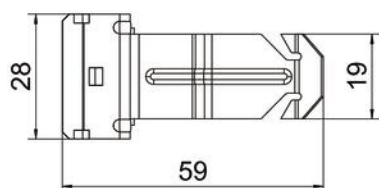

### Technical data

Connection type/component	Pipe/cable
Fastening type	Clamp
Flange thickness F max.	4 mm
Flange thickness F min.	1.5 mm
Pipe/cable diameter, max.	30 mm
Pipe/cable diameter, min.	22 mm
Hinge, adjustable	no
Hinged	no